

# The Preserve at Northfork

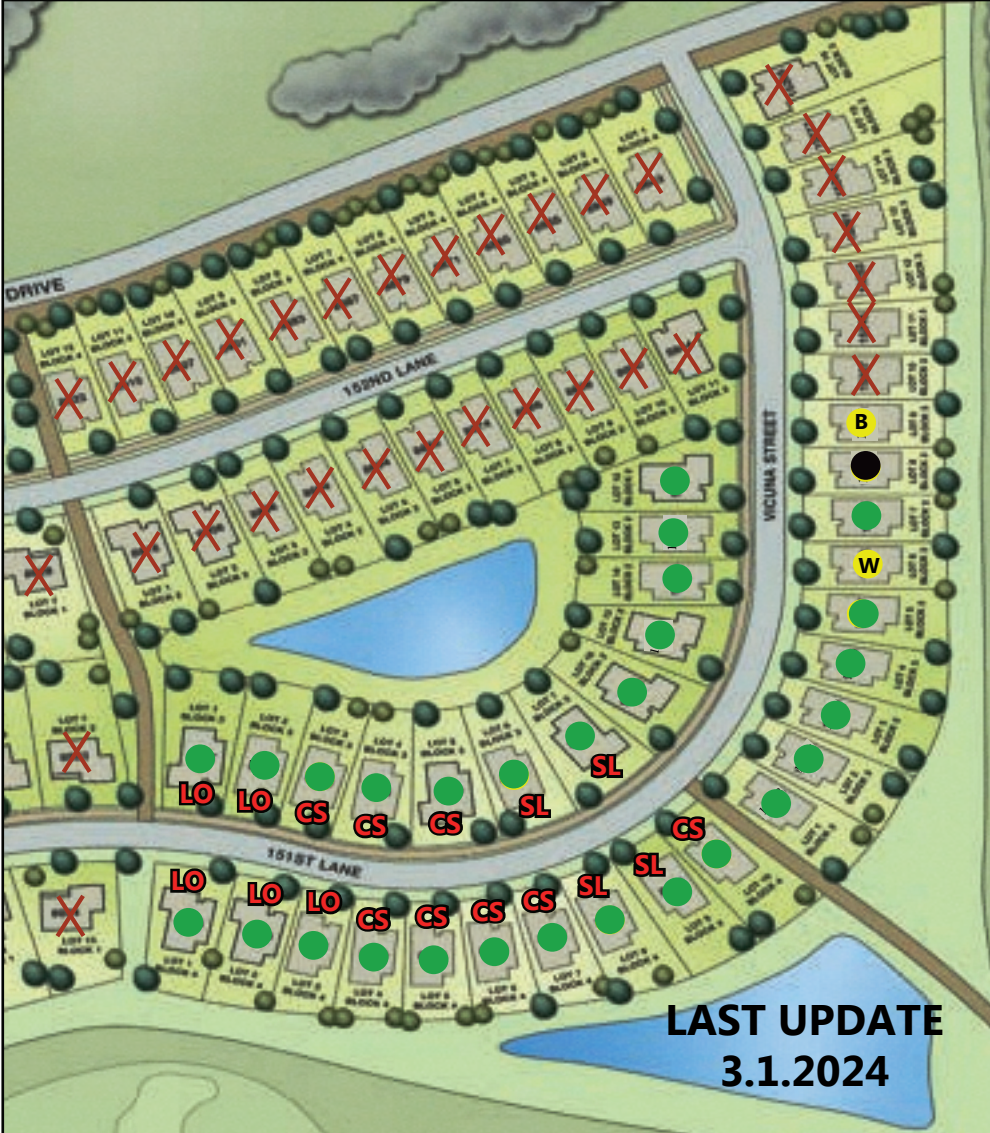

## LOT INFO

- = SOLD
- = ON HOLD
- = MODEL OR SPEC

## BASEMENT TYPES

- CS = Crawl Space
- LO = Lookout (no longer available)
- SL = Slab

## MODEL TYPES

- A = Ashton
- B = Birchmere
- M = Mapleton
- W = Wilshire

## NOTES

- ✗ = not Lewis Custom Homes
- \$500 lot hold is good for one week.
- \$20,000 lot premium on golf course views.
- \$10,000 lot premium on pond lots.

## MODELS

BLOCK	LOT	ADDRESS	TYPE	CAR	AVAILABILITY	STYLE
3	2	8891 151st Ln NW	LO	2	MODEL - SOLD	WILSHIRE
3	3	8889 151st Ln NW	CS	2	MODEL - SOLD	WILSHIRE
3	6	8861 151st Ln NW	SL	2	MODEL - SOLD	BIRCHMERE

## AVAILABLE LOTS

BLOCK	LOT	ADDRESS	BASEMENT	CAR	AVAILABILITY
2	12	15214 Vicuna St	CS	3	<b>SOLD</b>
2	13	15208 Vicuna St	CS	2	<b>SOLD</b>
2	14	15198 Vicuna St	CS	2	<b>SOLD</b>
2	15	15186 Vicuna St	CS	3	<b>SOLD</b>
2	16	15168 Vicuna St	CS	3	<b>SOLD</b>
3	1	8897 151st Ln NW	LO	3	<b>SOLD</b>
3	4	8881 151st Ln NW	CS	2	<b>SOLD</b>
3	5	8869 151st Ln NW	CS	3	<b>SOLD</b>
3	7	8853 151st Ln NW	SL	3	<b>SOLD</b>
4	1	8896 151st Ln NW	LO	3	<b>SOLD</b>
4	2	8890 151st Ln NW	LO	3	<b>SOLD</b>
4	3	8884 151st Ln NW	LO	2	<b>SOLD</b>
4	4	8880 151st Ln NW	CS	2	<b>SOLD</b>
4	5	8876 151st Ln NW	CS	2	<b>SOLD</b>
4	6	8864 151st Ln NW	CS	2	<b>SOLD</b>
4	7	8862 151st Ln NW	CS	2	<b>SOLD</b>
4	8	8856 151st Ln NW	SL	2	<b>SOLD</b>
4	9	8854 151st Ln NW	SL	2	<b>SOLD</b>
4	10	8850 151st Ln NW	CS	2	<b>SOLD</b>
(2nd ADDITION)					
3	1	15153 Vicuna St	CS	3	<b>SOLD</b>
3	2	15165 Vicuna St	CS	2	<b>SOLD</b>
3	3	15171 Vicuna St	CS	2	<b>SOLD</b>
3	4	15185 Vicuna St	CS	2	<b>SOLD</b>
3	5	15193 Vicuna St	CS	2	<b>SOLD</b>
3	6	15203 Vicuna St	CS	2	<b>AVAILABLE</b>
3	7	15211 Vicuna St	CS	2	<b>SOLD</b>
3	8	15217 Vicuna St	CS	2	<b>HOLD</b>
3	9	15227 Vicuna St	CS	2	<b>AVAILABLE</b>